

# DATASHEET

## DALTON-D22

### COB LENS:

DALTON-D22 is a versatile COB optics family with supreme light quality .

The product has a deep concave mirror surface structure with an anti glare angle of up to 30 degrees, greatly solving the problem of visible glare.

### 1.General Information

LENS Material	: PMMA (clear)
Socket Material	: PC (white)
Size	: Ø22mm
Design LED	: Cree CXA 1304
Compatibility	: ≤9.6mm LES
Fasten	: Clips+Screw
IP class	: N/A
Zhaga	: NO
RoHS	: YES
Color	: Clear



### 2.MECHANICAL SPECIFICATION

UNIT:mm

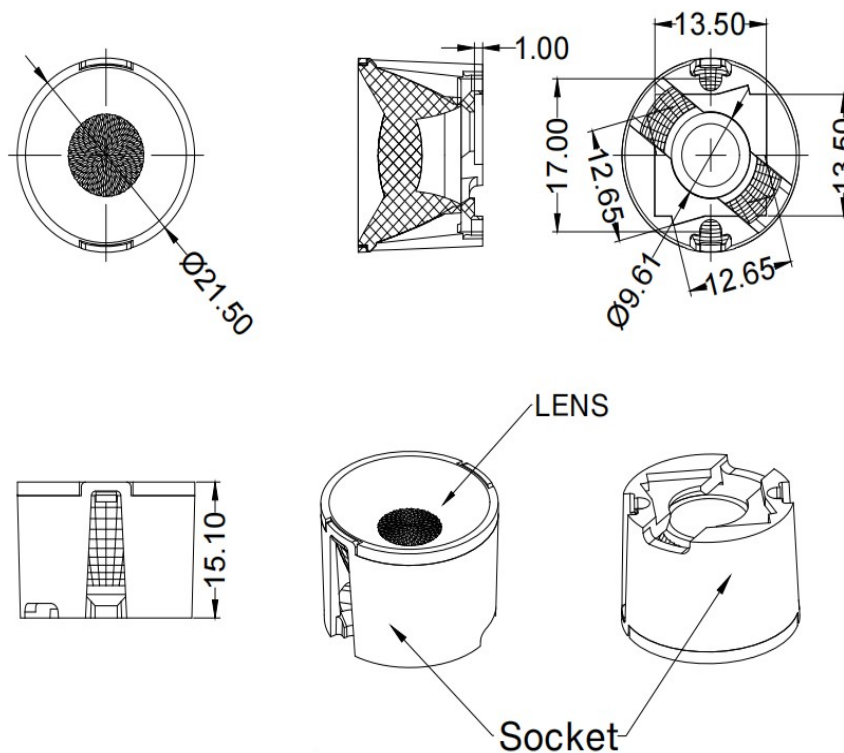

Dimensions with unmarked tolerances refer to GBT14486 tolerance table.

### 3. OPTICAL RESULTS

#### PRODUCTS:

S09.01.01.140  
DALTON-D22-15

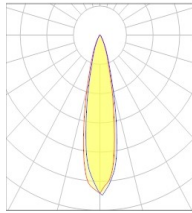

15° Extra Narrow beam

S09.01.01.141  
DALTON-D22-24

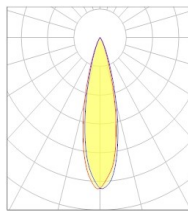

24° Narrow beam

S09.01.01.142  
DALTON-D22-36

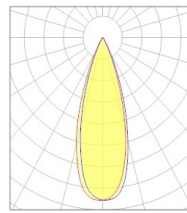

36° Medium beam

S09.01.01.143  
DALTON-D22-50

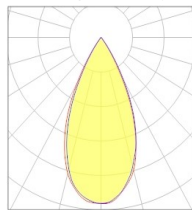

50° Wide beam

### 4.Usage and Maintenance

- 1) If necessary, clean lenses with mild soap, water and soft cloth.
- 2) Never use any commercial cleaning solvents on lenses, like alcohol.
- 3) Please handle lens with wearing gloves, skin oils may damage lens or its optical characteristic.

### 5.Note

Please test the data again before using. The chart data is for reference only.

The appearance and specifications of the product can be changed to improve the quality and/or performance without notice.

#### SUNLUMIN OPTICS CO.,LTD

2nd Floor, Building D, No.56 Liuhe Road, Tangkeng Community,  
Henggang Street, Longgang District, Shenzhen

E  
info@sunlumin-optics.com

www.  
sunlumin-optics.com