

DATASHEET

S01.01.01.389_MAXWELL -16-45X90

Street Lighting:

45x90° beam.

50 x 50 mm. 16 lens for up to 3030 size LED packages.

1.General Information

Lens Material	: PC
Size	: 50X50mm
typ.FWHM	: 85.8, 46.5
typ.FWTM	: 122.8, 107.5
Design LED	: Samsung LM302D
Compatibility	: 3030/2835
typ.Efficiency	: 93%
Fasten	: Screw
IP class	: N/A
Zhaga	: YES
RoHS	: YES
Color	: Clear

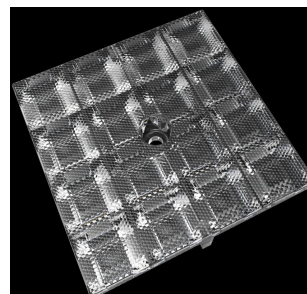

2.MECHANICAL SPECIFICATION

UNIT:mm

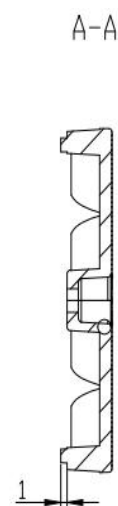
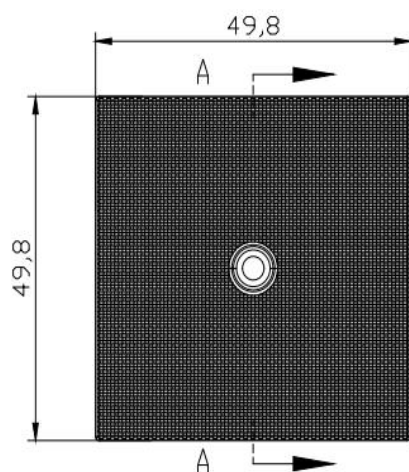

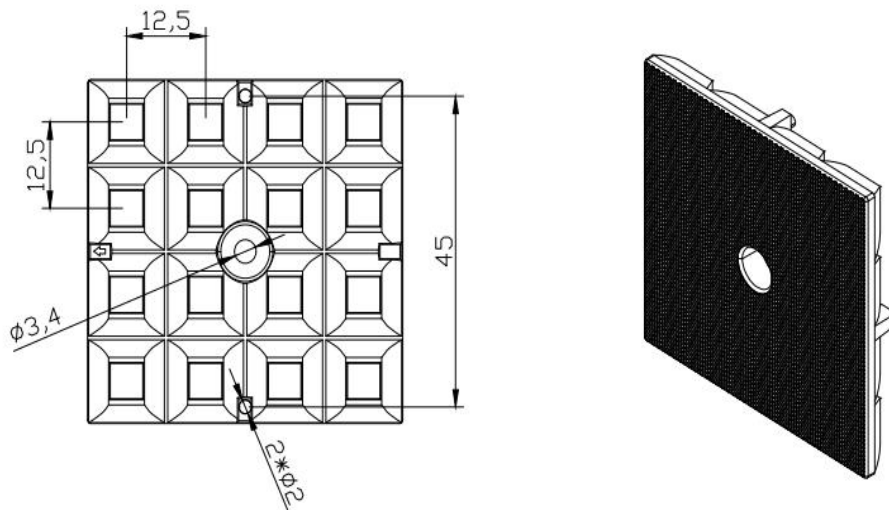

Dimensions with unmarked tolerances refer to GBT14486 tolerance table.

3. OPTICAL RESULTS

1) PHOTOMETRIC DATA(MEASURED):

SAMSUNG

LED model Samsung LM302D

Light colour White

LEDs/each optic 1

FWHM V46.5° x H 85.8°

FWTM V107.5° x H122.8°

Required components:

Glass

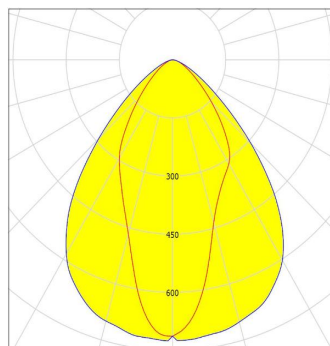

4.Usage and Maintenance

- 1) If necessary, clean lenses with mild soap, water and soft cloth.
- 2) Never use any commercial cleaning solvents on lenses, like alcohol.
- 3) Please handle lens with wearing gloves, skin oils may damage lens or its optical characteristic.

5.Note

Please test the data again before using. The chart data is for reference only.

The appearance and specifications of the product can be changed to improve the quality and/or performance without notice.

SUNLUMIN OPTICS CO.,LTD

2nd Floor, Building D, No.56 Liuhe Road, Tangkeng Community,
Henggang Street, Longgang District, Shenzhen

E
info@sunlumin-optics.com

www.
sunlumin-optics.com