

# DATASHEET

S01.01.01.358\_MAXWELL-12-40\_3030

## Area Lighting:

~40° (medium ) beam .

Designed for area lighting.

50x 50 mm, 12 leds for up to 3030 size LED packages.

## 1.General Information

Lens Material	: PC
Size	: 50X50mm
typ.FWHM	: 40°
Design LED	: Luxeon 3030
Compatibility	: 3030
typ.Efficiency	: 94%
Fasten	: Screw
IP class	: N/A
Zhaga	: N/A
RoHS	: YES
Color	: Clear



## 2.MECHANICAL SPECIFICATION

UNIT:mm

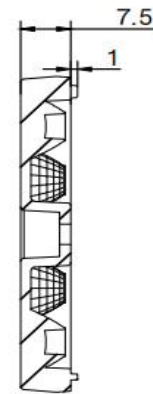
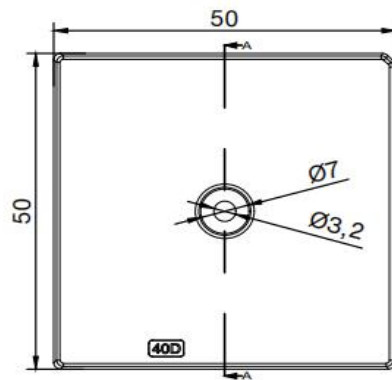

A-A

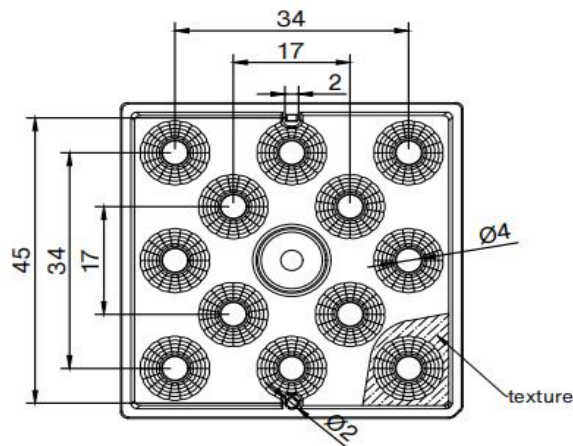
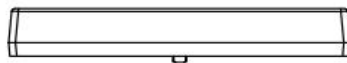

Dimensions with unmarked tolerances refer to GBT14486 tolerance table.

### 3. OPTICAL RESULTS

#### 1) PHOTOMETRIC DATA(SIMULATED):



LED model      Luxeon 3030 Square

Light colour    White

LEDs/each optic   1

FWHM            : H44.3°, V44°

FWTM            : H68.6°, V68.5°

Required components:

Glass

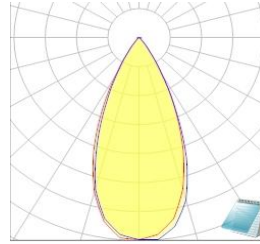

### 4.Usage and Maintenance

- 1) If necessary, clean lenses with mild soap, water and soft cloth.
- 2) Never use any commercial cleaning solvents on lenses, like alcohol.
- 3) Please handle lens with wearing gloves, skin oils may damage lens or its optical characteristic.

### 5.Note

Please test the data again before using. The chart data is for reference only.

The appearance and specifications of the product can be changed to improve the quality and/or performance without notice.